

Ô6 Lotus

360° Car Seat - R129

Rear Facing: Child height 40cm-105cm/ Child weight $\leq 19.5\text{kg}$

Forward Facing: Child age $\geq 15\text{m}$ / Child height 76cm-105cm
/ Child weight $\leq 19.5\text{kg}$

Booster: Child height 100cm-125cm/ Child weight $\leq 25\text{kg}$

IMPORTANT - READ THE INSTRUCTIONS CAREFULLY BEFORE USE AND KEEP FOR FUTURE REFERENCE

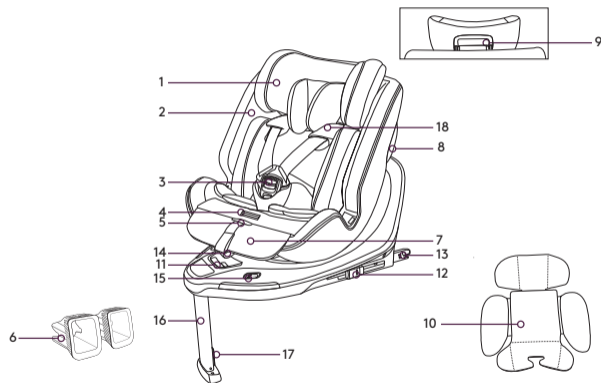

- 1 Head Support
- 2 Seat Pad
- 3 5-point Safety Harness
- 4 Internal Recline Button
- 5 Harness Adjustment Button
- 6 Plastic ISOFIX Guides
- 7 Recline Button
- 8 Side Protection System
- 9 Headrest Adjustment Handle

- 10 Insert Cushion
- 11 Rotation Button
- 12 ISOFIX Adjuster Button
- 13 ISOFIX Connector Arms
- 14 Child Restraint Release Strap
- 15 Misuse Button
- 16 Support leg
- 17 Support Leg Adjustment Button
- 18 Shoulder Pad

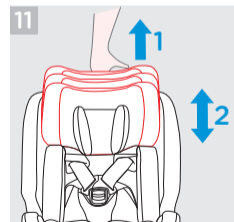
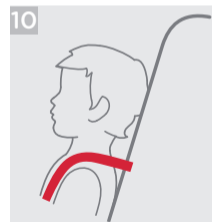
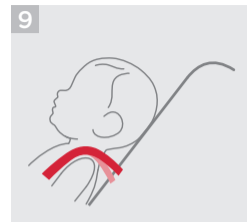
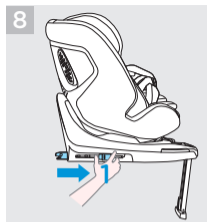
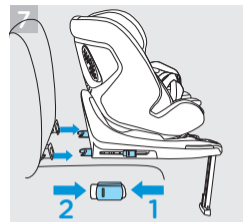
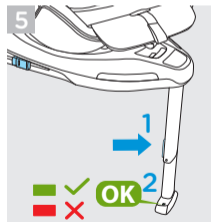
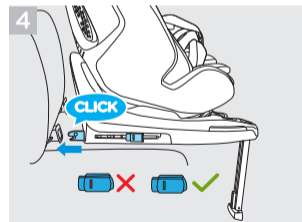
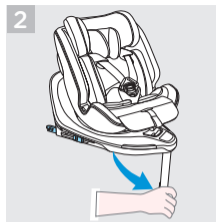
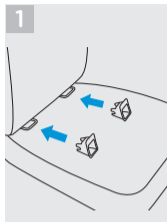

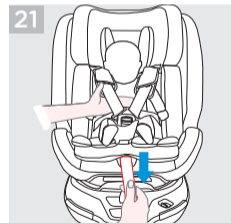
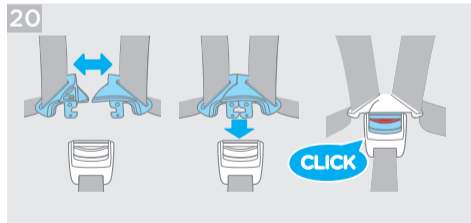
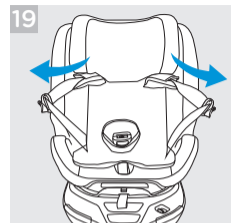
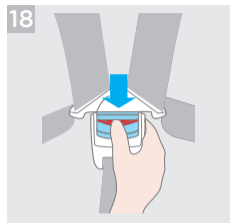
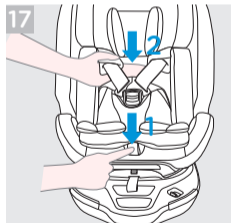
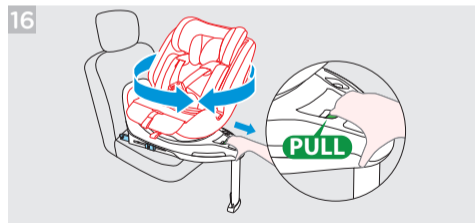
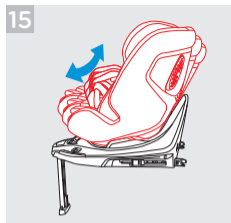

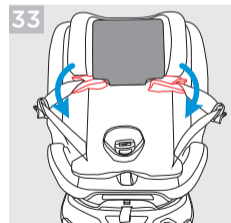
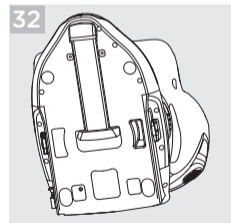
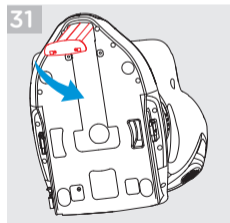
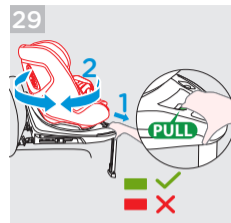
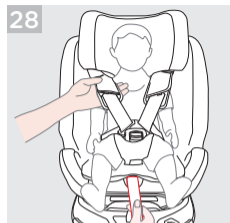
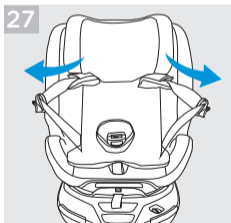
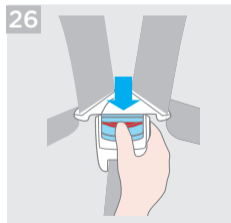
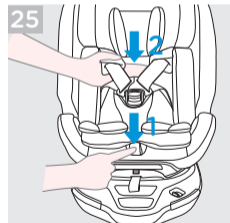
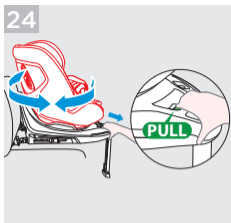
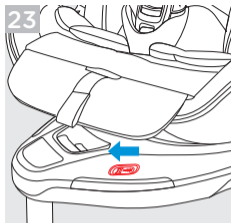
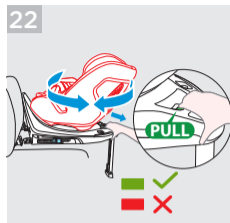

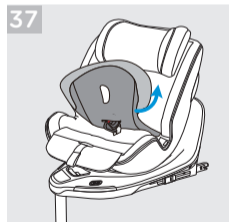
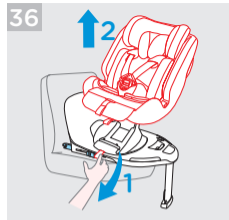
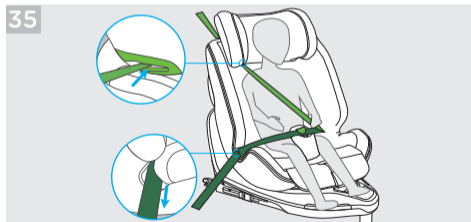
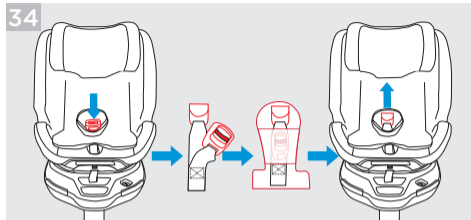

Welcome to Nado

You have purchased a high quality, fully certified child safety child restraint. This product is suitable for the use of children with height and weight up to 125cm and 25kg.

Carefully read this Instruction Manual and follow the installing steps because this is the **ONLY** way to protect your child from serious injury or death in case of an accident, and to provide comfort to your child while using this product.

Keep this instruction manual for future reference.

Please confirm

To use this Nado enhanced child restraint with the i-Size ISOFIX connections according to the UN Regulation No.129, your child must meet the following requirements.

Rear Facing: Child height 40cm-105cm/ max. 19.5kg;

Forward Facing: Child age $\geq 15m$ / Child height 76cm-105cm/ Child weight $\leq 19.5kg$;

Booster: Child height 100cm-125cm/ Child weight $\leq 25kg$;

Please read all the instructions in this manual before installing and using the product.

! IMPORTANT: KEEP FOR FUTURE REFERENCE. PLEASE READ CAREFULLY.

Warnings

This child restraint system has been approved under Regulation 129 for children of between 40 cm and 125 cm in height.

DO NOT use the rearward facing enhanced child restraint system in seating positions where there is an active frontal airbag installed.

Please do not leave the child unattended in the vehicle. Please read these instructions carefully. Incorrect installation of the child restraint system may cause the child serious injury. If used incorrectly, the manufacturer cannot be held responsible.

This seat is included in UN Regulation 129 and can be installed in all vehicles approved under Regulation 16. It can also be installed in the vehicles included on the list attached to this instruction manual.

The rigid items and plastic parts of an Enhanced Child Restraint System shall be located and installed so that they are not liable to become trapped by a movable seat or in a door of the vehicle during everyday use of

the vehicle.

Do not use the safety seat without its cover and without the harness pads.

Protect the child restraint system from direct contact with sunlight, the plastic and metal parts may heat up and burn the child.

Keep the child restraint system away from corrosive liquids, paints or solvents that could damage the product. The child restraint system should be replaced after an accident, even if there are no visible signs of damage. The product may have unseen internal damage that could compromise the child's safety.

Take regular breaks when travelling so the child can get out of the seat and walk around a bit. It is not advisable to travel for more 2 hours at a time without taking a break. This advice is very important for babies.

Make sure that the support leg is always in contact with the vehicle floor, and that the child's harness is correctly fitted and not twisted at all.

Make sure the lap strap is worn low down so that the pelvis is firmly engaged.

Do not make any alterations or additions to the product without the approval of the Type Approval Authority. Follow closely the installation instructions provided by the child restraint manufacturer.

The Enhanced Child Restraint System shall not be used without the cover.

The Enhanced Child Restraint System cover should not be replaced with any other than the one recommended by the manufacturer, because the cover constitutes an integral part of the restraint performance.

Do not leave unsecured luggage or objects on the parcel shelf in the vehicle, because in the event of an accident they could cause serious injury to the occupants.

If you have any queries, please contact your retailer or: NADO

Emergency

In case of emergency or accidents, it is most important to have your child taken care of with first aid and medical treatment immediately.

Product Information

For installation with ISOFIX system

1. This is an " i-Size " Enhanced Child Restraint System. It is approved according to UN Regulation No.129, for use in, i-Size compatible vehicle seating positions as indicated by vehicle manufacturers in the vehicle users' manual.

2. If in doubt, consult either the Enhanced Child Restraint System manufacturer or the retailer.

For installation with 3-point belt



For installation with 3-point belt + ISOFIX system





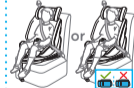

1. This is an i-Size booster seat Enhanced Child Restraint System. It is approved according to UN Regulation No.129, for use primarily in "i-Size seating positions" as indicated by vehicle manufacturers in the vehicle user's manual.

2. If in doubt, consult either the Enhanced Child Restraint System manufacturer or the retailer.

Materials Plastics, metal, fabrics

Choose Your Installation

	Child's Size	Installation Mode	Figure for Installation	Reference Age	Internal Position	Seat Position
ECE R129	40cm-105cm/ ≤ 18kg	Rear Facing Mode		< 4 years	Position 1-3	The most reclined
	76cm-105cm/ ≤ 18kg	Forward Facing Mode		15 months to 4 years	Upright	Position 1-4
	100cm-125cm/ ≤ 25kg	Booster Mode		3.5 years to 7 years	Upright	Position 1-4

Child's Age	Installation Mode	Installation	Misuse Button
≤15 Months	Rear facing mode	 	
>15 Months	Rear/Forward facing mode	 	

Installation Concerns

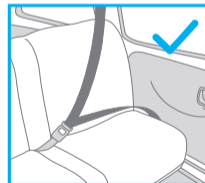
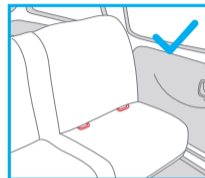

Installation

see images (1) - (8)

1. Attach the ISOFIX guides to the vehicle's ISOFIX anchor points (see vehicle owner's manual). (1) The ISOFIX guides can protect the surface of the vehicle seat from being torn. They can also guide the ISOFIX connectors.

2. Unfold the load leg from storage compartment. (2)

3. Extend the ISOFIX connectors by pressing the ISOFIX adjustment button while pulling on the connector. (3)

4. Press the ISOFIX adjustment button to adjust the ISOFIX connectors. Line up the ISOFIX connectors with the ISOFIX guides, and then click both ISOFIX connectors into the ISOFIX anchor points. (4)

Make sure that both ISOFIX connectors are securely attached to the vehicle's ISOFIX anchor points. There should be two audible clicks and the colors of the indicators on both ISOFIX connectors should be completely green. (4)

Check to make sure the base is securely installed by pulling on both ISOFIX connectors.

5. After placing the base on the vehicle seat, extend the load leg to floor (5). When the load leg is installed correctly, the load leg indicator will show green. Red will be shown when installed incorrectly. (5-2)

The load leg has multiple positions. When the load leg indicator shows red this means the load leg is in the wrong position.

Make sure the load leg is in full contact with the vehicle floor pan.

Squeeze the load leg adjustment button, then shorten the load leg upwards. (5-1)

6. The completely assembled base is shown as (6).

The ISOFIX connectors must be attached and locked onto the ISOFIX anchor points. (6-1)

The load leg must be installed correctly with green indicator. (5-2)

Always make sure the support load leg has direct contact with the floor and is in locked position even when the child is not in it.

Removing the Seat

7. To remove the seat from the vehicle seat, push the secondary lock buttons (7-1) first and then press the ISOFIX releasing buttons (7-2) on the ISOFIX connectors before removing the seat from the vehicle seat. (7)

8. For transporting, press ISOFIX adjustment button and move the ISOFIX connectors back into the storage position. (8)

Height Adjustment

for Head Support and Shoulder Harnesses

see images (9) - (11)

1. Please adjust the head support and check if the shoulder harnesses are at the correct height according to (9) & (10) & (11)

When used in rearward facing mode, the shoulder harness height must be even with or just below the top of child's shoulders. (9)

When used in forward facing mode, the shoulder harness height must be even with the top of child's shoulders. (10)

Pull the head support adjustment lever (11-1), meanwhile pull up or down the head support until it snaps into one of the 6 positions. The head support positions are shown as (11-2).

Recline Adjustment

see images (12) - (15)

Squeeze the internal recline adjustment button to adjust the enhanced child restraint to the proper position. (12)
Rear facing mode have 3 recline positions, the recline angles are shown as. (13)

Squeeze the recline adjustment button to adjust the enhanced child restraint to the proper position. (14)

Forward facing mode have 4 recline positions, the recline angles are shown as. (15)

Using in the Rear Facing Mode

(Child height 40cm-105cm/Child weight ≤ 18kg /infant - 4 years old)

see images (16) - (22)

Please install the enhanced child restraint on the rear vehicle seat and then put the child in the enhanced child

restraint.

Press the rotating button to rotate for easier side loading/unloading of the child, then rotate the seat to the rear facing position. (16)

1. To lengthen the shoulder harness belts, press the harness adjustment button while pulling out the shoulder harnesses to loosen. (17)

2. Unlock the buckle of the harnesses by pressing the red button. (18)

3. Place the buckle tongues against the magnetic area on the outer side of the enhanced child restraint so that the tongues are held in place. (19)

Use Infant Insert

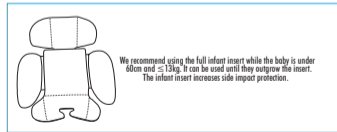

4. Place the child into the enhanced child restraint and pass both arms through the harnesses.

5. Engage the buckle. Please refer to (20)

6. Pull down the adjustment webbing and adjust it to the proper length to make sure your child is properly secured. (21)

Always keep child secured in harness and properly tightened by removing any slack.

Make sure the space between the child and the shoulder harness straps is about the thickness of one hand.

When the seat is rotated in place and properly engaged, rotation button will show green; otherwise it will show red. (22)

Always make sure the seat is in locked position (rearward facing / forward facing) even when the child is not in it.

Using in the e forward facing Mode

(Child height 76cm-105cm/Child weight ≤ 18kg /15 months - 4 years old)

see images (23) - (30)

Please install the enhanced child restraint on the rear vehicle seat, and then place the child in the enhanced child restraint.

Please slide misuse button to left to rotate the enhanced child restraint to the forward facing mode. (23)

Press the rotation button to rotate for easier side loading/unloading of the child, then rotate the seat to the forward facing position. (24)

1. To lengthen the shoulder harness belts, press the harness adjustment button while pulling out the shoulder harnesses to loosen. (25)

2. Unlock the buckle of the harnesses by pressing the red button. (26)

3. Place the buckle tongues against the magnetic area on the

outer side of the enhanced child restraint so that the tongues are held in place. (27)

6. Pull down the adjustment webbing and adjust it to the proper length to make sure your child is properly secured. (28)

7. Press the swivel lock off button (29-1) while you rotate the seat to the forward facing mode. (29-2)

When the seat is rotated in place and properly engaged, rotation button will show green, otherwise it will show red. (29)

Always make sure the seat is in locked position (rearward facing / forward facing) even when the child is not in it.

The ISOFIX connectors must be attached and locked onto the ISOFIX anchor points. (30-1)

The load leg must be installed correctly with green indicator. (30-1)

Always keep child secured in harness and properly tightened by removing any slack.

DO NOT use forward facing mode until your child's height

is at least 76cm AND 15 months old.

Using in the booster mode

(Child height 100cm-125cm/Child weight 25kg/3.5 - 7 years old)

see images (31) - (35)

Install the enhanced child restraint on the rear vehicle seat, and then place the child in the enhanced child restraint.

Remove the infant insert when booster mode.

Fold the load leg into the compartment underneath the base. (31) & (32)

Securing Child

1. Unlock the buckle of the harnesses by pressing the red button.

2. Turn the shoulder pad outwards as shown (33) and pull out to remove, keep it properly.

3. Tuck the shoulder strap away in the compartments, store the buckle into the frontal pocket of crotch pad take out of the abdominal belt guider from the back pocket of crotch pad. (34)

4. Adjust the headrest so the bottom of the headrest is level with the child's shoulders.

5. Buckle up with the vehicle belt.

Shoulder belt must pass through shoulder and abdominal belt guide. (35)

The colors of the indicators on both ISOFIX attachments connectors should be completely green.

The enhanced child restraint can not be used if the vehicle safety belt buckle (female buckle end) is too long to anchor the enhanced child restraint securely. (35)

*The seat is detachable from base. (36)

MAINTENANCE

Fitting / Removing the cover

The cover of the NADO 06 Lotus seat is very easy to remove. There are 4 fastening points for the cover on the front. Unfasten these points and gently pull the front part of the cover. (37)

There are plastic parts on the sides of the cover used to fasten it in place. Simply pull gently to remove the cover. (37)

To fit the cover back on, follow the same steps in reverse · insert the side parts in the slot.

Cleaning

The cover can be machine washed using mild detergent and at a maximum temperature of 30°. Please follow the Washing instructions on the care label on the cover.

Do not tumble dry the cover as the podding could come away from the fabric.

Do not expose the cover to sunlight for prolonged periods, when the seat is not in use cover it up or store it in the luggage compartment.

The plastic parts can be cleaned with a damp cloth and neutral detergent.

Recommendations

Keep this instruction book for future reference.

Always store it in the compartment on the backrest of the seat.

Make sure that all luggage as well as any other object that could cause an injury in the event of an accident is properly secured or fastened inside the vehicle.

APPROVED CARS FOR O6 Lotus CAR SEAT

Approved cars for the O6 Lotus provided that the car is equipped with ISOFIX. The O6 Lotus base is also suitable for fixing into the seat positions of the cars listed below, providing approved ISOFIX points are fitted and available. Seat positions in other cars may also be suitable to accept this child restraint, however we have not yet tested that combination of car with the O6 Lotus. If in doubt, consult either alina or the retailer.

ISOFIX anchorage in the passenger seat (position 1) are normally offered as an option, so depending on the model this position can be available or not. Installation in the rear seat of a car can limit the space for a passenger in the front seat. Always check the O6 Lotus in your car to verify if the available space is acceptable for your situation.

NOTICE: DO NOT USE ON A PASSENGER SEAT FITTED WITH ACTIVATED FRONTAL AIRBAG.

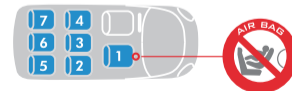

Car manufacturer	Model	1st year of production	Approved seats
Alfa Romeo	Giulia	2017>	2,4
	Guilietta	2010>	2,4
Audi	Stelvio	2017>	2,4
	A3	1996>	2,4
	A3 Hatch	2012>	2,4
	A3 S3	2012>	2,4
	A3 Saloon	2014>	2,4
	A3 e-Tron Sportback	2015>	2,4
	A4	2005>	2,4
	A4 Avant	2008>	2,4
	A5 Sportback	2009>	2,4
	A5/S5 Cabriolet	2017>	2,4
	A5/S5 Coupe	2016>	2,4
	A5/S5 Sportback	2017>	2,4
	A6 Allroad	2011>	2,4
	A6 Avant	2011>	2,4
	A7 Sportback	2011>	2,4
	A7/S7 Sportback	2016>	2,4
	A8	2011>	2,4
	A8 S8	2011>	2,4
	Q2	2016>	2,4
	Q3	2011>	2,4
	Q5	2009>	2,4
	Q5/SQ5	2017>	2,4
	Q7	2006>	2,4
	Q8	2018>	2,4

Car manufacturer	Model	1st year of production	Approved seats
BMW	1 Series (f20)	2011>	2,4
	1-Series 5dr	2004>	2,4
	1-Series Cabrio	2008>	2,4
	1-Series Coupe	2008>	2,4
	2-Series AC-T	2015>	2,4
	2-Series Coupe	2014>	2,4
	3 Series (f30)	2012>	2,4
	3-Series (E46) Coupe	2002>	2,4
	3-Series Coupe (E90)	2007>	2,4
	4-Series Gran Coupe	2014>	2,4
	5-GT	2010>	2,4
	5-Series (F10)	2011>	2,4
	5-Series (E60)	2003>	2,4
	5-Series	2018>	2,4
	6-Series Cabrio	2011>	2,4
	6-Series Coupe (2Dr)	2011>	2,4
	6-Series Gran Coupe (4Dr)	2011>	2,4
	7-Series	2010>	2,4
	7-Series 2015	2015>	2,4
	X1	2009>	2,4
	X3 (F25)	2011>	2,4
	X3	2018>	2,4
	X4	2014>	2,4
	X5	2007>	2,4
	X6	2009>	2,4
	Continental Flying Spur	2005>	2,4

Car manufacturer	Model	1st year of production	Approved seats
Bmw	Mulsanne	2012 >	2,4
	3GT	2013 >	2,4
Cadillac	i3	2014 >	2,4
	BLS	2005 >	2,4
Chevrolet	Captiva	2010 >	2,4
	Cruze	2011 >	2,4
	Orlando	2011 >	2,4
	Traxx	2013 >	2,4
	Volt	2011 >	2,4
Chrysler	300C	2012 >	2,4
	Delta	2007 >	2,4
	Grand Voyager	2008 >	2,4
	C-Cactus	2015 >	2,4
Alfa Romeo	C3 5Dr	2009 >	2,4
	C3 Aircross	2017 >	2,4
	C5	2005 >	2,4
	C5 Aircross	2019 >	2,4
	C5 Tourer	2009 >	2,4
	DS3 Cabrio	2013 >	2,4
	DS3 Crossback	2019 >	2,4
	DS4	2011 >	2,4
	DS5	2013 >	2,4
	DS7	2018 >	2,4
	Jumpy	2007 >	2,4
	Nemo	2008 >	2,4
	Xsara Picasso	2000 >	2,4

Car manufacturer	Model	1st year of production	Approved seats
Dacia	Duster	2012 >	2,4
	Logan MCV	2008 >	2,4
	Sandero	2013 >	2,4
FIAT	500L	2013 >	2,4
	500X	2015 >	2,4
	Bravo	2007 >	2,4
	Doblo	2007 >	2,4
	Qubo	2008 >	2,4
	Tipo	2016 >	2,4
FORD	Galaxy	2016 >	2,4
Ford	B-Max	2012 >	2,4
	C-Max	2011 >	2,4
	EcoSport	2015 >	2,4
	Edge SBI	2016 >	2,4
	Fiesta	2008 >	2,4
	Focus	2010 >	2,4
	Focus EV	2015 >	2,4
	Galaxy	2006 >	2,4
	Ka+	2016 >	2,4
	Kuga	2008 >	2,4
	Mondeo Estate	2007 >	2,4
	New Mondeo	2014 >	2,4
	Puma	2020 >	2,4
	Ranger Double-Cab Pickup	2019 >	2,4
	S-Max	2006 >	2,4
	S-Max	2015 >	2,4

Car manufacturer	Model	1st year of production	Approved seats
Genesis	G80	2021 >	2,4
	GV80 SUV	2021 >	2,4
Honda	Accord Saloon	2008 >	2,4
	CR-V	2007 >	2,4
	Civic	2006 >	2,4
	Civic Saloon	2019 >	2,4
	Civic Tourer	2014 >	2,4
	E	2021 >	2,4
	Elysion	2012 >	2,4
	FRV	2006 >	2,4
	HR-V	2015 >	2,4
	Insight	2009 >	2,4
	Jazz	2008 >	2,4
	Jazz Crosstar	2021 >	2,4
Hyundai	Genesis Sedan	2016 >	2,4
	Getz	2005 >	2,4
	Ioniq Hybrid	2016 >	2,4
	Ix20	2011 >	2,4
	Kona	2017 >	2,4
	Santa Fe	2007 >	2,4
	Tucson	2015 >	2,4
	i10	2014 >	2,4
	i20	2014 >	2,4
	i30 Hatch	2012 >	2,4
	i40	2011 >	2,4
	i800/H1	2008 >	2,4

Car manufacturer	Model	1st year of production	Approved seats
Infiniti	ix35	2010 >	2,4
	EX SUV	2009 >	2,4
	FX SUV	2009 >	2,4
	G Saloon	2009 >	2,4
	M Saloon	2010 >	2,4
Jaguar	E-Pace	2016 >	2,4
	I-Pace	2018 >	2,4
	XE	2015 >	2,4
	XF	2008 >	2,4
	XF Estate	2015 >	2,4
	XF Sportbrake	2012 >	2,4
	XJ	2010 >	2,4
Jeep	Cherokee	2014 >	2,4
	Compass	2011 >	2,4
	Grand Cherokee	2011 >	2,4
	Renegade	2015 >	2,4
KIA	Ceed	2020 >	2,4
	Sorento	2015 >	2,4
	Sorento	2020 >	2,4
	Soul EV	2015 >	2,4
	XCeed	2020 >	2,4
Kia	Carens	2013 >	2,4
	Cee'D Hatch	2012 >	2,4
	Niro	2017 >	2,4
	Optima	2011 >	2,4
	Picanto	2011 >	2,4

Car manufacturer	Model	1st year of production	Approved seats
	Rio	2012 >	2,4
	Sorento	2003 >	2,4
	Soul	2009 >	2,4
	Sportage	2011 >	2,4
	Stonic	2017 >	2,4
Lancia	Venga	2011 >	2,4
	Thema	2012 >	2,4
	Voyager	2010 >	2,4
Land-Rover	Defender	2020 >	2,4
	Discovery	2009 >	2,4
	Discovery 5	2017 >	2,4,5,7
	Discovery Sport	2015 >	2,4
	Freelander 2	2006 >	2,4
	Range Rover	2002 >	2,4
	Range Rover Evoque	2011 >	2,4
	Range Rover Evoque (5dr)	2011 >	2,4
	Range Rover Sport	2005 >	2,4
	Range Rover VELAR	2017 >	2,4
Lexus	CT	2011 >	2,4
	ES Hybrid	2019 >	2,4
	GS	2013 >	2,4
	IS	2005 >	2,4
	IS 200	1999 >	2,4
	NX	2014 >	2,4
	RX	2010 >	2,4
	UX	2019 >	2,4

Car manufacturer	Model	1st year of production	Approved seats
MG	5 EV Estate	2020 >	2,4
	GS	2016 >	2,4
	HS PHEV SUV	2021 >	2,4
	HS SUV	2021 >	2,4
	Motor MG6	2012 >	2,4
MINI	ZS	2021 >	2,4
	ZS EV	2021 >	2,4
	Countryman	2010 >	2,4
	Hatchback 3dr	2014 >	2,4
	Hatchback 5dr	2015 >	2,4
Maserati	Paceman	2013 >	2,4
	Ghibli	2014 >	2,4
	Gran Turismo	2007 >	2,4
	Levante	2017 >	2,4
	Quattroporte	2016 >	2,4
Mazda	2	2007 >	2,4
	3 Hatch	2009 >	2,4
	3 Hatchback	2014 >	2,4
	5	2005 >	2,4
	6	2007 >	2,4
	6 Estate	2013 >	2,4
	6 Saloon	2013 >	2,4
	CX-3	2015 >	2,4
	CX-5	2011 >	2,4
	CX-7	2007 >	2,4
Mercedes-Benz A-Class		2005 >	2,4

Car manufacturer	Model	1st year of production	Approved seats
	A-Class Hatchback	2019 >	2,4
	A-Class Saloon	2019 >	2,4
	B-Class	2012 >	2,4
	B-Class EV	2015 >	2,4
	C-Class Estate	2008 >	2,4
	C-Class Coupe	2011 >	2,4
	CLA	2013 >	2,4
	CLS Shooting Brake	2012 >	2,4
	CLS Coupe	2011 >	2,4
	E-Class	2006 >	2,4
	E-Class Cabriolet	2017 >	2,4
	E-Class Coupe	2009 >	2,4
	E-Class Estate	2013 >	2,4
	E-Class Saloon	2013 >	2,4
	EQA	2021 >	2,4
	EQC	2021 >	2,4
	GL Class	2012 >	2,4
	GLA	2021 >	2,4
	GLC	2016 >	2,4
	GLC Coupe	2019 >	2,4
	GLE	2015 >	2,4
	ML-Class	2005 >	2,4
	R-Class	2006 >	2,4
	S-Class	2006 >	2,4
	V-Class	2015 >	2,4,5,7
	ASX	2010 >	2,4
Mitsubishi			

Car manufacturer	Model	1st year of production	Approved seats
	Eclipse Cross	2019 >	2,4
	Lancer	2008 >	2,4
	Lancer Sportback	2008 >	2,4
	Mirage	2012 >	2,4
	Outlander	2007 >	2,4
	Outlander PHEV	2015 >	2,4
	Shogun	2007 >	2,4
Nissan	X-Trail	2008 >	2,4
	Juke	2010 >	2,4
	Leaf EV	2010 >	2,4
	Micra	2011 >	2,4
	Murano	2016 >	2,4
	Navara	2015 >	2,4
	Note	2006 >	2,4
	Pulsar	2015 >	2,4
	Qashqai	2006 >	2,4
	Qashqai +2	2008 >	2,4
	Quest MPV	2012 >	2,4
	X-Trail	2015 >	2,4
Opel	Agila	2008 >	2,4
	Ampera	2011 >	2,4
	Antara	2007 >	2,4
	Astra 5dr	2003 >	2,4
	Astra	2015 >	2,4
	Astra GTC	2011 >	2,4
	Corsa 5dr	2015 >	2,4

Car manufacturer	Model	1st year of production	Approved seats
	Corsa Hatch 5dr	2006 >	2,4
	Insignia Hatch	2009 >	2,4
	Meriva	2010 >	2,4
	Mokka	2013 >	2,4
	Vectra	2002 >	2,4
	Zafira	2005 >	2,4
	Zafira Tourer	2012 >	2,4
	Peugeot 2008	2013 >	2,4
	206 3dr	1998 >	2,4
	207 5dr	2012 >	2,4
	208 5dr	2012 >	2,4
	208 EV 5dr	2020 >	2,4
	3008	2017 >	2,4
	307 Hatchback	2001 >	2,4
	308	2014 >	2,4
	308 Hatchback	2007 >	2,4
	407	2004 >	2,4
	5008 SBI	2000 >	2,3,4
	508	2011 >	2,4
	508 Estate PHEV	2019 >	2,4
	Bipper Tepee	2008 >	2,4
	Expert Tepee	2008 >	2,4
	Traveller	2016 >	2,3,4,5,6,7
Polestar	2	2021 >	2,4
Porsche	Cayenne	2011 >	2,4
	Cayenne E-Hybrid	2015 >	2,4

Car manufacturer	Model	1st year of production	Approved seats
	Macan	2014 >	2,4
	Panamera	2011 >	2,4
	Panamera E-Hybrid	2015 >	2,4
Renault	Clio	2005 >	2,4
	Espace	2003 >	2,3,4
	Grand Espace	2003 >	2,3,4
	Kadjar	2015 >	2,4
	Laguna Sport Tourer	2008 >	2,4
	Megane Hatch	2002 >	2,4
	Modus	2004 >	2,4
	New Clio	2013 >	2,4
SAAB	93 Sport Wagon	2005 >	2,4
	New 95	2011 >	2,4
SEAT	Altea	2004 >	2,4
	Ateca	2018 >	2,4
	Exeo ST	2008 >	2,4
	Ibiza	2018 >	2,4
	Leon FR	2006 >	2,4
	Leon	2000 >	2,4
	New Toledo	2013 >	2,4
	Leon	2013 >	2,4
Skoda	Enyaq EV	2021 >	2,4
	Fabia	2021 >	2,4
	Karoq	2017 >	2,4
	Kodiaq	2017 >	2,4
	Octavia	2004 >	2,4

Car manufacturer	Model	1st year of production	Approved seats
	Octavia Hatch	2013 >	2,4
	Rapid	2013 >	2,4
	Roomster	2006 >	2,4
	Superb	2015 >	2,4
	Superb Combi/Estate	2008 >	2,4
Ssangyong	Yeti	2009 >	2,4
	Actyon	2006 >	2,4
	Korando	2011 >	2,4
	Musso Pickup	2016 >	2,4
	Rexton	2014 >	2,4
	Tivoli	2015 >	2,4
	Turismo	2014 >	2,4
	Forester	2013 >	2,4
Subaru	Impreza 5dr	2007 >	2,4
	Impreza Hatchback	2013 >	2,4
	Legacy	2012 >	2,4
	Levorg	2014 >	2,4
	Outback	2012 >	2,4
	XV Hatchback	2011 >	2,4
Suzuki	Baleno	2016 >	2,4
	Celerio	2016 >	2,4
	Grand Vitara	2005 >	2,4
	Ignis	2016 >	2,4
	SX-4 5dr	2006 >	2,4
	Swift	2017 >	2,4
	Vitara	2015 >	2,4

Car manufacturer	Model	1st year of production	Approved seats
Tesla	Model 3	2017 >	2,4
	Model S	2012 >	2,4
	Model X	2015 >	2,4,5,7
Toyota	Verso	2013 >	2,4
	Auris	2007 >	2,4
	Avenis Hatch	2003 >	2,4
	Aygo	2019 >	2,4
	C-HR	2017 >	2,4
	Corolla	2018 >	2,4
	EZ Mpv	2013 >	2,4
	Highlander	2013 >	2,4
	Land Cruiser	2003 >	2,4
	Landcruiser	2009 >	2,4
	Prius 2	2004 >	2,4
	Prius 3	2010 >	2,4
	Prius 4	2015 >	2,4
	Prius PHEV 3	2015 >	2,4
	Prius Plus+	2012 >	2,4
	RAV4	2006 >	2,4
	RAV4 Hybrid	2015 >	2,4
	Yaris	2017 >	2,4
VW	Beetle	2012 >	2,4
	E-Golf Hatch Mk7	2015 >	2,4
	Golf GTE Hatch Mk7	2015 >	2,4
	Golf Hatch	2009 >	2,4
	Golf Hatch Mk5	2004 >	2,4

Car manufacturer	Model	1st year of production	Approved seats
	Golf Hatch Mk7	2012 >	2,4
	Golf Plus	2009 >	2,4
	ID3 EV	2020 >	2,4
	ID4 EV	2021 >	2,4
	Jetta	2011 >	2,4
	Multivan Caravelle	2008 >	2,4,5,7
	Passat CC	2008 >	2,4
	Passat Estate	2005 >	2,4
	Passat Saloon	2005 >	2,4
	Polo	2017 >	2,4
	Scirocco	2011 >	2,4
	T-Cross	2019 >	2,4
	T-Roc	2017 >	2,4
	Tiguan	2008 >	2,4
	Tiguan Allspace	2017 >	2,4
	Touareg	2003 >	2,4
	Touran	2016 >	2,3,4,5,7
Vauxhall	Agila	2008 >	2,4
	Ampera	2011 >	2,4
	Antara	2007 >	2,4
	Astra 5dr	2010 >	2,4
	Astra	2015 >	2,4
	Astra GTC	2011 >	2,4
	Corsa 5dr	2015 >	2,4
	Corsa Hatch 5dr	2006 >	2,4
	Insignia Hatch	2009 >	2,4

Car manufacturer	Model	1st year of production	Approved seats
	Meriva	2010 >	2,4
	Mokka	2013 >	2,4
	Vectra	2005 >	2,4
	Zafira	2005 >	2,4
	Zafira Tourer	2012 >	2,4
	Opel Crossland X	2018 >	2,4
	Opel Grandland X	2019 >	2,4
	Opel Insignia	2018 >	2,4
Volvo	C30	2007 >	2,4
	S40	2004 >	2,4
	S90	2016 >	2,4
	V40	2013 >	2,4
	V40 Cross Country	2013 >	2,4
	V50	2004 >	2,4
	V60	2011 >	2,4
	V60 Plug-In	2015 >	2,4
	V90	2016 >	2,4
	XC40	2018 >	2,4
	XC60	2013 >	2,4
	XC70	2008 >	2,4
	XC90	2003 >	2,4



nado GmbH
Langgasse 15
95326 Kulmbach Germany
www.babynado.de