

Ö1 Lotus

360° Car Seat - R129

Rearward Facing: Child height 40cm-87cm/ Child weight \leq 13kg;

IMPORTANT - READ THE INSTRUCTIONS CAREFULLY BEFORE USE AND KEEP FOR FUTURE REFERENCE

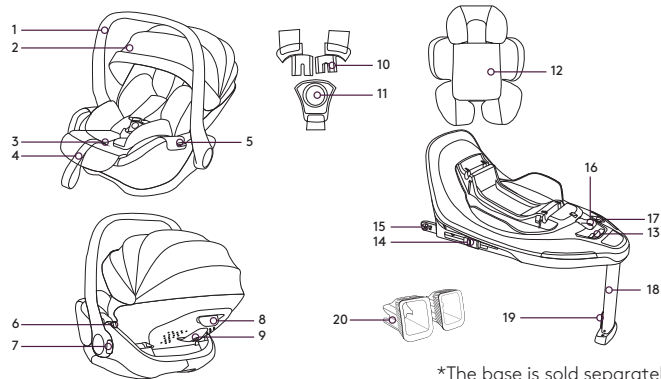

- 1 Handle
- 2 Canopy
- 3 Webbing Adjustment Button
- 4 Adjustment Webbing
- 5 Side Guide
- 6 Stroller Fix Releasing Button
- 7 Handle Adjustment Button
- 8 Backrest Adjustment Button
- 9 Rear Guide
- 10 Harness Connector

- 11 Buckle
- 12 Insert Cushion
- 13 Rotation Button
- 14 ISOFIX Adjuster Button
- 15 ISOFIX Connector Arms
- 16 Child Restraint Release Strap
- 17 Misuse Button
- 18 Support leg
- 19 Support Leg Adjustment Button
- 20 Plastic ISOFIX Guides

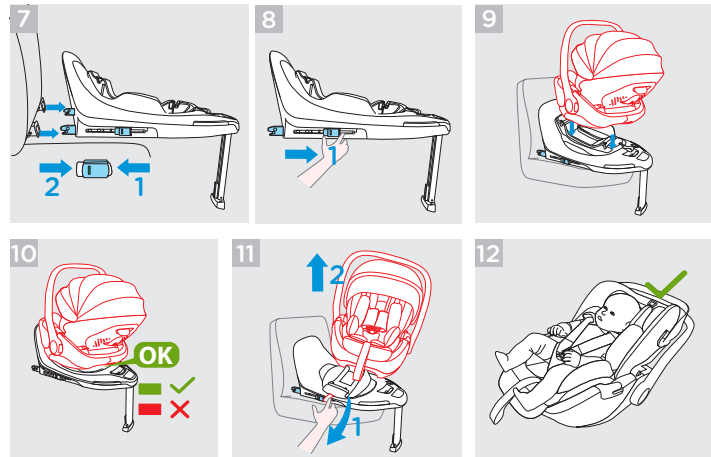
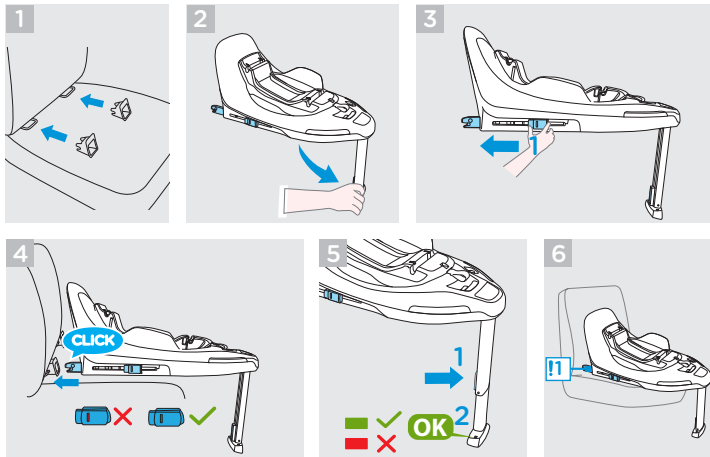

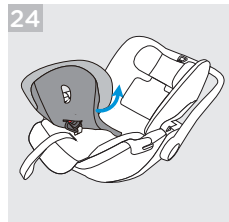
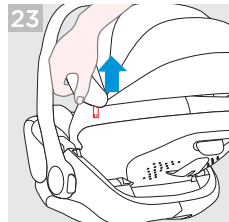
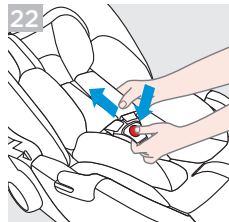
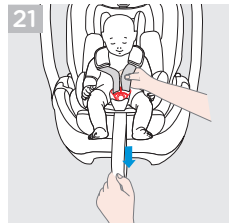
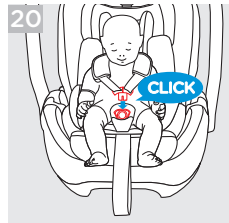
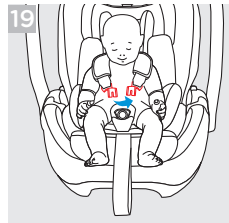
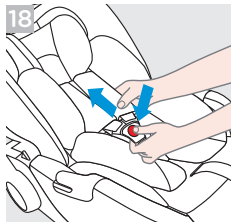
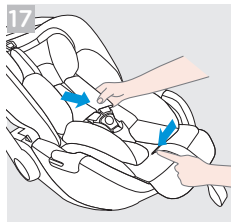
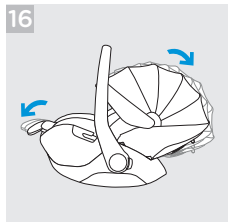
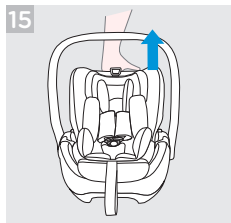
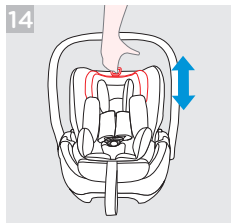

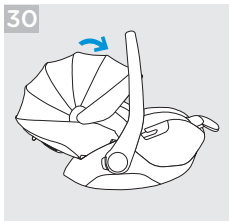
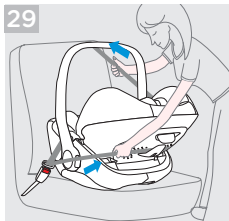
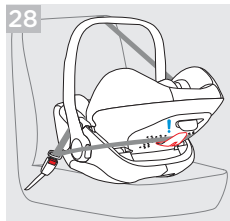
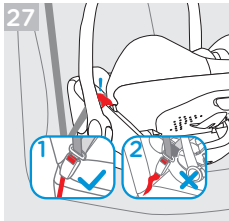
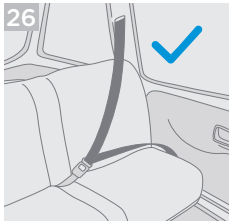
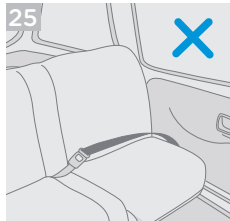

Welcome to Nado

You have purchased a high quality, fully certified enhance child safety enhanced child restraint. This product is suitable for the use of child's height and weight up to 87cm and 13kg.

Carefully read this Instruction Manual and follow the installing steps because this is the **ONLY** way to protect your child from serious injury or death in case of an accident, and to provide comfort to your child while using this product.

Keep this instruction manual for future reference.

Please confirm

To use this Nado enhanced Infant child restraint according to the UN Regulation No.129,your child must meet the following requirements.

Child height 40cm-87cm/ Child weight \leq 13kg

Please read all the instructions in this manual before installing and using the product.

! IMPORTANT: KEEP FOR FUTURE REFERENCE. PLEASE READ CAREFULLY.

Warnings

Please check before you purchase this enhanced infant child restraint to make sure it can be installed properly in your vehicle.

NO enhanced infant child restraint can guarantee full protection from injury in an accident. However, proper use of this enhanced infant child restraint will reduce the risk of serious injury or death to your child.

To use this enhanced infant child restraint according to the ECE R129/04 Regulation, your child must meet the following requirements.

01 Lotus: Child height 40cm-87cm/ Child weight ≤ 13 kg (approximately 1.5 years old or under).

Any straps holding the enhanced child restraint to the vehicle should be tight; any support-leg should be in contact with the vehicle floor; any straps or impact shields restraining the child should be adjusted to the child's body, and that straps should not be twisted.

DO NOT install this enhanced infant child restraint without following the instructions in this manual or

you may put your child at serious risk of injury or death. NEVER leave your child unattended with this enhanced infant child restraint.

DO NOT make any modification to this enhanced infant child restraint or use it along with component parts from other manufacturers.

DO NOT use this enhanced infant child restraint if it has damaged or missing parts.

DO NOT have your child in large/oversized clothes because this may prevent your child from being properly and securely fastened by the shoulder harness straps and the crotch strap between the legs.

DO NOT use this enhanced infant child restraint without the soft goods.

The soft goods should not be replaced with any besides the ones recommended by the manufacturer. The soft goods constitute an integral part of the enhanced infant child restraint performance.

DO NOT put anything other than the recommended inner

cushions in this enhanced infant child restraint.

Be sure that the enhanced infant child restraint is installed in such a way that no part of it interferes with movable seats or in the operation of vehicle doors.

DO NOT continue to use this enhanced infant child restraint after it has suffered any type of crash, even a minor one. Replace immediately as there may be invisible, structural damage from the crash.

Remove this infant carrier module and base from the vehicle seat when it is not in regular use.

Consult the distributor for issues concerning maintenance, repair and part replacement.

To avoid the risk of falling out, always secure the child using the child harness when the child is placed in infant carrier module, even when the enhanced infant child restraint is not in the vehicle.

Before carrying the infant carrier module by hand, ensure that the child is fastened with the child harness, and that the handle is correctly locked in a vertical

position.

To avoid serious injury or death, NEVER place infant carrier module on elevated surface seat with child in it.

The parts of this enhanced infant child restraint should not be lubricated in any way.

Always secure child in enhanced infant child restraint, even on short trips, as this is when most accidents occur.

Frequently check the ISOFIX guides for dirt and clean them if necessary. Reliability can be effected by ingress of dirt, dust, food particles etc.

DO NOT leave this enhanced infant child restraint or other items unbelted or unsecured in your vehicle because an unsecured enhanced infant child restraint can be thrown around and may injure occupants in a sharp turn, sudden stop, or collision.

DO NOT place a rear-facing enhanced infant child restraint on front seat with activated front airbag. Death or serious injury may occur. Please reference vehicle owner's manual for more information.

DO NOT place any objects in the Support leg area in front of your base.

DO NOT use any load bearing contact points other than those described in the instructions and marked on the enhanced infant child restraint.

Please do not use this enhanced child restraint if the enhanced child restraint has dropped from a significant height, hit the ground at a considerable speed, or has visible signs of damage. We are not responsible to replace if the car seat has been damaged under these abnormal conditions. A new car seat will need to be purchased when any of the aforementioned conditions occurs.

Emergency

In case of emergency or accidents, it is most important to have your child taken care of with first aid and medical treatment immediately.

Product Information

With the i-Size ISOFIX connections

1. This is an i-Size Enhanced Child Restraint System. It is approved according to UN Regulation No.129, for use in, i-Size compatible vehicle seating positions as indicated by vehicle manufacturers in the vehicle users' manual.

2. If in doubt, consult either the Enhanced Child Restraint System manufacturer or the retailer.

With vehicle belt



1. This is Universal Belted Enhanced Child Restraint System. It is approved according to UN Regulation NO 129. for use primarily in "Universal seating positions" as

indicated by vehicle manufacturers in the vehicle user's manual.

2. If in doubt, consult either the Enhanced Child Restraint System manufacturer or the retailer.

Materials Plastics, metal, fabrics

Choose Your Installation

Figure for Installation	Suitable for
	Child height 40cm-87cm/ Child weight ≤13kg (approximately 1.5 years old or under)
	Child height 40cm-87cm Child weight ≤13kg Child age ≤18 months

01 Lotus is compatible with Lotus Base. For the use with Lotus Base, please refer to the individual base's manual.

Installation Concerns

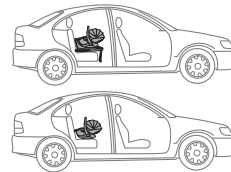
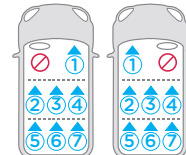
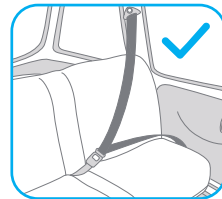
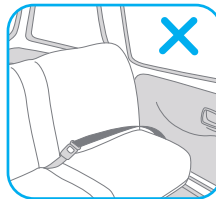
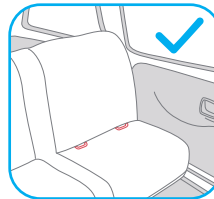

This infant carrier module is suitable for vehicle seats with i-Size ISOFIX anchor points with the base.

DO NOT install this enhanced infant child restraint on vehicle seats that face sideways or rearward with respect to the moving direction of the vehicle.

DO NOT place rear-facing enhanced infant child restraint on front seat with air bag, because death or serious injury may occur. Please reference vehicle owner's manual for more information.

It is recommended to install this enhanced infant child restraint on the rear vehicle seat.

DO NOT install this enhanced infant child restraint on vehicle seats movable during installation.

Handle Adjustment

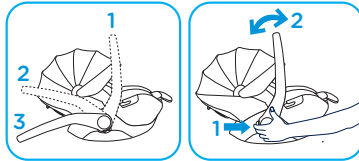

The handle of the infant carrier module can be adjusted to 3 positions.

Position for car, hand or stroller transportation.

To adjust the handle, squeeze the handle buttons on both sides to release it, and then rotate the handle until it clicks into any of the 3 positions.

Installation with base

see images (1) - (11)

1. Attach the ISOFIX guides to the vehicle's ISOFIX anchor points (see vehicle owner's manual). (1) The ISOFIX guides can protect the surface of the vehicle seat from being torn. They can also guide the ISOFIX connectors.
 2. Unfold the support leg from storage compartment. (2)
 3. Extend the ISOFIX connectors by pressing the ISOFIX adjustment button while pulling on the connector. (3)
 4. Press the ISOFIX adjustment button to adjust the ISOFIX connectors. Line up the ISOFIX connectors with the ISOFIX guides, and then click both ISOFIX connectors into the ISOFIX anchor points. (4)
- Make sure that both ISOFIX connectors are securely attached to the vehicle's ISOFIX anchor points. There should be two audible clicks and the colors of the indicators on both ISOFIX connectors should be completely green. (4)

Check to make sure the base is securely installed by pulling on both ISOFIX connectors.

5. After placing the base on the vehicle seat, extend the support leg to floor (5). When the support leg is installed correctly, the support leg indicator will show green. Red will be shown when installed incorrectly. (5-2)
- The support leg has multiple positions. When the support leg indicator shows red this means the support leg is in the wrong position.

Make sure the support leg is in full contact with the vehicle floor pan.

Squeeze the support leg adjustment button, then shorten the support leg upwards. (5-1)

6. The completely assembled base is shown as (6).
- The ISOFIX connectors must be attached and locked onto the ISOFIX anchor points. (6-1)
- The support leg must be installed correctly with green indicator. (5-2)

Always make sure the support support leg has direct contact with the floor and is in locked position even when the child is not in it.

Removing the Base

7. To remove the base from the vehicle seat, push the secondary lock buttons (7-1) first and then press the ISOFIX releasing buttons (7-2) on the ISOFIX connectors before removing the base from the vehicle seat. (7)
8. For transporting, press ISOFIX adjustment button and move the ISOFIX connectors back into the storage position. (8)
9. Push the infant carrier module down into the base (9) , if the enhanced infant child restraint is secure, the enhanced infant child restraint indicator shows green. (10)
Pull up on the infant carrier module to be sure it is securely latched into the base.
10. To release the infant carrier, pull the infant carrier up (11-2) while pulling the infant carrier release strap. (11-1)
It's much easy to be released when the infant carrier module is in loading position.

Height Adjustment for Head Support and Shoulder Harnesses

see images (12) - (14)

- Check that Shoulder Harness Straps are set at the proper height. Please choose the proper pair of shoulder harness slots according to the child's height.
The bottom of headrest must be level with the highest point of child's shoulder, it is shown as (12), but not above the shoulder line.(13)
If the Shoulder Harness Straps are not at proper height, the child might be ejected from the enhanced infant child restraint if there is a crash.
Pull the head support adjustment loop, meanwhile pull up or push down the head support until it snaps into one of the 6 positions. The head support positions are shown as (14)

Backrest Adjustment

see images (15) - (16)

There are 3 angles for the backrest.
Please press backrest adjustment button (15) to heighten or lower the backrest. (16)

Securing Child in the enhanced Infant Child Restraint

see images (17) - (21)

Note

1. Insert cushion is for children's protection. Children whose height is under 60cm are suitable to use the infant insert.
2. After the child is placed in the seat, check if the shoulder harnesses are set to the correct height.



Remove the insert cushion when the infant's shoulders no longer fit comfortably.

1. While pressing the harness adjustment button, pull completely the two shoulder harnesses of the enhanced infant child restraint. (17)
2. Unlock the buckle of the harnesses by pressing the red button. (18)
3. Place child into the infant carrier module and lock the buckle. (19) & (20)
4. Tighten the shoulder harnesses by pulling adjustment webbing. (21)

Detaching Canopy and Seat Pad

see images (22) - (24)

To re-assemble the soft goods, reverse the aforementioned steps.

Installation without base

see images (25) - (30)

DO NOT install this infant carrier module on vehicle seats with Lap Belts. (25)

This infant carrier module is suitable for vehicle seats with a 3-point Retractor Safety Belt only. (26)

1. Place the infant carrier module onto the vehicle seat where you wish to put it. Pull the vehicle safety belt out and lock it into the vehicle buckle, sliding the vehicle lap belt into the side guides of the infant carrier module. (27)

The infant carrier module can not be used if the vehicle afety belt buckle (female buckle end) is too long to anchor

the infant carrier module securely. (27-2)

2. Slide diagonal belt into the rear guide. (28)

3. Pull the vehicle shoulder belt to fasten the infant carrier module tightly and securely. (29)

Tension the vehicle safety belt as much as possible, checking that it is not loose or twisted.

After installing the infant carrier module, always check that the vehicle belts are routed correctly and securely fastened into the vehicle buckle.

5. The hood can be opened completely to protect your child from the sun uttermostly, just pull the hood toward front. (30)

APPROVED CARS FOR O1 Lotus CAR SEAT

Approved cars for the O1 Lotus provided that the car is equipped with ISOFIX. The O1 Lotus is also suitable for fixing into the seat positions of the cars listed below, providing approved ISOFIX points are fitted and available. Seat positions in other cars may also be suitable to accept this child restraint, however we have not yet tested that combination of car with the O1 Lotus. If in doubt, consult either alina or the retailer.

ISOFIX anchorage in the passenger seat (position 1) are normally offered as an option, so depending on the model this position can be available or not. Installation in the rear seat of a car can limit the space for a passenger in the front seat. Always check the O1 Lotus in your car to verify if the available space is acceptable for your situation.

NOTICE: DO NOT USE ON A PASSENGER SEAT FITTED WITH ACTIVATED FRONTAL AIRBAG.

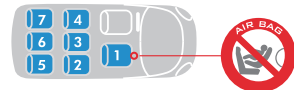

Car manufacturer	Model	1st year of production	Approved seats
Alfa Romeo	Giulia	2017 >	2,4
	Guilietta	2010 >	2,4
	Stelvio	2017 >	2,4
Audi	A3	1996 >	2,4
	A3 Hatch	2012 >	2,4
	A3 S3	2012 >	2,4
	A3 Saloon	2014 >	2,4
	A3 e-Tron Sportback	2015 >	2,4
	A4	2005 >	2,4
	A4 Avant	2008 >	2,4
	A5 Sportback	2009 >	2,4
	A5/S5 Cabriolet	2017 >	2,4
	A5/S5 Coupe	2016 >	2,4
	A5/S5 Sportback	2017 >	2,4
	A6 Allroad	2011 >	2,4
	A6 Avant	2011 >	2,4
	A7 Sportback	2011 >	2,4
	A7/S7 Sportback	2016 >	2,4
	A8	2011 >	2,4
	A8 S8	2011 >	2,4
	Q2	2016 >	2,4
	Q3	2011 >	2,4
	Q5	2009 >	2,4
	Q5/SQ5	2017 >	2,4
	Q7	2006 >	2,4
	Q8	2018 >	2,4

Car manufacturer	Model	1st year of production	Approved seats
BMW	1 Series (f20)	2011 >	2,4
	1-Series 5dr	2004 >	2,4
	1-Series Cabrio	2008 >	2,4
	1-Series Coupe	2008 >	2,4
	2-Series AC-T	2015 >	2,4
	2-Series Coupe	2014 >	2,4
	3 Series (f30)	2012 >	2,4
	3-Series (E46) Coupe	2002 >	2,4
	3-Series Coupe (E90)	2007 >	2,4
	4-Series Gran Coupe	2014 >	2,4
	5-GT	2010 >	2,4
	5-Series (F10)	2011 >	2,4
	5-Series (E60)	2003 >	2,4
	5-Series	2018 >	2,4
	6-Series Cabrio	2011 >	2,4
	6-Series Coupe (2Dr)	2011 >	2,4
	6-Series Gran Coupe (4Dr)	2011 >	2,4
	7-Series	2010 >	2,4
	7-Series 2015	2015 >	2,4
	X1	2009 >	2,4
	X3 (F25)	2011 >	2,4
Bentley	X3	2018 >	2,4
	X4	2014 >	2,4
	X5	2007 >	2,4
	X6	2009 >	2,4
	Continental Flying Spur	2005 >	2,4

Car manufacturer	Model	1st year of production	Approved seats
Bmw	Mulsanne	2012 >	2,4
	3GT	2013 >	2,4
Cadillac	i3	2014 >	2,4
	BLS	2005 >	2,4
Chevrolet	Captiva	2010 >	2,4
	Cruze	2011 >	2,4
	Orlando	2011 >	2,4
	Traxx	2013 >	2,4
	Volt	2011 >	2,4
Chrysler	300C	2012 >	2,4
	Delta	2007 >	2,4
	Grand Voyager	2008 >	2,4
	C-Cactus	2015 >	2,4
Alfa Romeo	C3 5Dr	2009 >	2,4
	C3 Aircross	2017 >	2,4
	C5	2005 >	2,4
	C5 Aircross	2019 >	2,4
	C5 Tourer	2009 >	2,4
	DS3 Cabrio	2013 >	2,4
	DS3 Crossback	2019 >	2,4
	DS4	2011 >	2,4
	DS5	2013 >	2,4
	DS7	2018 >	2,4
	Jumpy	2007 >	2,4
	Nemo	2008 >	2,4
	Xsara Picasso	2000 >	2,4

Car manufacturer	Model	1st year of production	Approved seats
Dacia	Duster	2012 >	2,4
	Logan MCV	2008 >	2,4
	Sandero	2013 >	2,4
FIAT	500L	2013 >	2,4
	500X	2015 >	2,4
	Bravo	2007 >	2,4
	Doblo	2007 >	2,4
	Qubo	2008 >	2,4
	Tipo	2016 >	2,4
FORD	Galaxy	2016 >	2,4
	B-Max	2012 >	2,4
	C-Max	2011 >	2,4
	EcoSport	2015 >	2,4
	Edge SBI	2016 >	2,4
	Fiesta	2008 >	2,4
	Focus	2010 >	2,4
	Focus EV	2015 >	2,4
	Galaxy	2006 >	2,4
	Ka+	2016 >	2,4
	Kuga	2008 >	2,4
	Mondeo Estate	2007 >	2,4
	New Mondeo	2014 >	2,4
	Puma	2020 >	2,4
	Ranger Double-Cab Pickup	2019 >	2,4
	S-Max	2006 >	2,4
	S-Max	2015 >	2,4

Car manufacturer	Model	1st year of production	Approved seats
Genesis	G80	2021 >	2,4
	GV80 SUV	2021 >	2,4
Honda	Accord Saloon	2008 >	2,4
	CR-V	2007 >	2,4
	Civic	2006 >	2,4
	Civic Saloon	2019 >	2,4
	Civic Tourer	2014 >	2,4
	E	2021 >	2,4
	Elysion	2012 >	2,4
	FRV	2006 >	2,4
	HR-V	2015 >	2,4
	Insight	2009 >	2,4
	Jazz	2008 >	2,4
	Jazz Crosstar	2021 >	2,4
Hyundai	Genesis Sedan	2016 >	2,4
	Getz	2005 >	2,4
	Ioniq Hybrid	2016 >	2,4
	Ix20	2011 >	2,4
	Kona	2017 >	2,4
	Santa Fe	2007 >	2,4
	Tucson	2015 >	2,4
	i10	2014 >	2,4
	i20	2014 >	2,4
	i30 Hatch	2012 >	2,4
	i40	2011 >	2,4
	i800/H1	2008 >	2,4

Car manufacturer	Model	1st year of production	Approved seats
Infiniti	ix35	2010 >	2,4
	EX SUV	2009 >	2,4
	FX SUV	2009 >	2,4
	G Saloon	2009 >	2,4
	M Saloon	2010 >	2,4
Jaguar	E-Pace	2016 >	2,4
	I-Pace	2018 >	2,4
	XE	2015 >	2,4
	XF	2008 >	2,4
	XF Estate	2015 >	2,4
	XF Sportbrake	2012 >	2,4
	XJ	2010 >	2,4
Jeep	Cherokee	2014 >	2,4
	Compass	2011 >	2,4
	Grand Cherokee	2011 >	2,4
	Renegade	2015 >	2,4
KIA	Ceed	2020 >	2,4
	Sorento	2015 >	2,4
	Sorento	2020 >	2,4
	Soul EV	2015 >	2,4
	XCeed	2020 >	2,4
Kia	Carens	2013 >	2,4
	Cee'D Hatch	2012 >	2,4
	Niro	2017 >	2,4
	Optima	2011 >	2,4
	Picanto	2011 >	2,4

Car manufacturer	Model	1st year of production	Approved seats
	Rio	2012 >	2,4
	Sorento	2003 >	2,4
	Soul	2009 >	2,4
	Sportage	2011 >	2,4
	Stonic	2017 >	2,4
	Venga	2011 >	2,4
	Thema	2012 >	2,4
	Voyager	2010 >	2,4
Land-Rover	Defender	2020 >	2,4
	Discovery	2009 >	2,4
	Discovery 5	2017 >	2,4,5,7
	Discovery Sport	2015 >	2,4
	Freelander 2	2006 >	2,4
	Range Rover	2002 >	2,4
	Range Rover Evoque	2011 >	2,4
	Range Rover Evoque (5dr)	2011 >	2,4
	Range Rover Sport	2005 >	2,4
	Range Rover VELAR	2017 >	2,4
Lexus	CT	2011 >	2,4
	ES Hybrid	2019 >	2,4
	GS	2013 >	2,4
	IS	2005 >	2,4
	IS 200	1999 >	2,4
	NX	2014 >	2,4
	RX	2010 >	2,4
	UX	2019 >	2,4

Car manufacturer	Model	1st year of production	Approved seats
MG	5 EV Estate	2020 >	2,4
	GS	2016 >	2,4
	HS PHEV SUV	2021 >	2,4
	HS SUV	2021 >	2,4
	Motor MG6	2012 >	2,4
MINI	ZS	2021 >	2,4
	ZS EV	2021 >	2,4
	Countryman	2010 >	2,4
	Hatchback 3dr	2014 >	2,4
	Hatchback 5dr	2015 >	2,4
Maserati	Paceman	2013 >	2,4
	Ghibli	2014 >	2,4
	Gran Turismo	2007 >	2,4
	Levante	2017 >	2,4
	Quattroporte	2016 >	2,4
Mazda	2	2007 >	2,4
	3 Hatch	2009 >	2,4
	3 Hatchback	2014 >	2,4
	5	2005 >	2,4
	6	2007 >	2,4
	6 Estate	2013 >	2,4
	6 Saloon	2013 >	2,4
	CX-3	2015 >	2,4
	CX-5	2011 >	2,4
	CX-7	2007 >	2,4
Mercedes-Benz	A-Class	2005 >	2,4

Car manufacturer	Model	1st year of production	Approved seats
	A-Class Hatchback	2019 >	2,4
	A-Class Saloon	2019 >	2,4
	B-Class	2012 >	2,4
	B-Class EV	2015 >	2,4
	C-Class Estate	2008 >	2,4
	C-Class Coupe	2011 >	2,4
	CLA	2013 >	2,4
	CLS Shooting Brake	2012 >	2,4
	CLS Coupe	2011 >	2,4
	E-Class	2006 >	2,4
	E-Class Cabriolet	2017 >	2,4
	E-Class Coupe	2009 >	2,4
	E-Class Estate	2013 >	2,4
	E-Class Saloon	2013 >	2,4
	EQA	2021 >	2,4
	EQC	2021 >	2,4
	GL Class	2012 >	2,4
	GLA	2021 >	2,4
	GLC	2016 >	2,4
	GLC Coupe	2019 >	2,4
	GLE	2015 >	2,4
	ML-Class	2005 >	2,4
	R-Class	2006 >	2,4
	S-Class	2006 >	2,4
	V-Class	2015 >	2,4,5,7
	ASX	2010 >	2,4
Mitsubishi			

Car manufacturer	Model	1st year of production	Approved seats
	Eclipse Cross	2019 >	2,4
	Lancer	2008 >	2,4
	Lancer Sportback	2008 >	2,4
	Mirage	2012 >	2,4
	Outlander	2007 >	2,4
	Outlander PHEV	2015 >	2,4
	Shogun	2007 >	2,4
Nissan	X-Trail	2008 >	2,4
	Juke	2010 >	2,4
	Leaf EV	2010 >	2,4
	Micra	2011 >	2,4
	Murano	2016 >	2,4
	Navara	2015 >	2,4
	Note	2006 >	2,4
	Pulsar	2015 >	2,4
	Qashqai	2006 >	2,4
	Qashqai+2	2008 >	2,4
	Quest MPV	2012 >	2,4
	X-Trail	2015 >	2,4
Opel	Agila	2008 >	2,4
	Ampera	2011 >	2,4
	Antara	2007 >	2,4
	Astra 5dr	2003 >	2,4
	Astra	2015 >	2,4
	Astra GTC	2011 >	2,4
	Corsa 5dr	2015 >	2,4

Car manufacturer	Model	1st year of production	Approved seats
	Corsa Hatch 5dr	2006 >	2,4
	Insignia Hatch	2009 >	2,4
	Meriva	2010 >	2,4
	Mokka	2013 >	2,4
	Vectra	2002 >	2,4
	Zafira	2005 >	2,4
	Zafira Tourer	2012 >	2,4
Peugeot	2008	2013 >	2,4
	206 3dr	1998 >	2,4
	207 5dr	2012 >	2,4
	208 5dr	2012 >	2,4
	208 EV 5dr	2020 >	2,4
	3008	2017 >	2,4
	307 Hatchback	2001 >	2,4
	308	2014 >	2,4
	308 Hatchback	2007 >	2,4
	407	2004 >	2,4
	5008 SBI	2000 >	2,3,4
	508	2011 >	2,4
	508 Estate PHEV	2019 >	2,4
	Bipper Tepee	2008 >	2,4
	Expert Tepee	2008 >	2,4
	Traveller	2016 >	2,3,4,5,6,7
Polestar	2	2021 >	2,4
Porsche	Cayenne	2011 >	2,4
	Cayenne E-Hybrid	2015 >	2,4

Car manufacturer	Model	1st year of production	Approved seats
	Macan	2014 >	2,4
	Panamera	2011 >	2,4
	Panamera E-Hybrid	2015 >	2,4
Renault	Clio	2005 >	2,4
	Espace	2003 >	2,3,4
	Grand Espace	2003 >	2,3,4
	Kadjar	2015 >	2,4
	Laguna Sport Tourer	2008 >	2,4
	Megane Hatch	2002 >	2,4
	Modus	2004 >	2,4
	New Clio	2013 >	2,4
SAAB	93 Sport Wagon	2005 >	2,4
	New 95	2011 >	2,4
SEAT	Altea	2004 >	2,4
	Ateca	2018 >	2,4
	Exeo ST	2008 >	2,4
	Ibiza	2018 >	2,4
	Leon FR	2006 >	2,4
	Leon	2000 >	2,4
	New Toledo	2013 >	2,4
	Leon	2013 >	2,4
Seat	Enyaq EV	2021 >	2,4
Skoda	Fabia	2021 >	2,4
	Karoq	2017 >	2,4
	Kodiaq	2017 >	2,4
	Octavia	2004 >	2,4

Car manufacturer	Model	1st year of production	Approved seats
	Octavia Hatch	2013 >	2,4
	Rapid	2013 >	2,4
	Roomster	2006 >	2,4
	Superb	2015 >	2,4
	Superb Combi/Estate	2008 >	2,4
Ssangyong	Yeti	2009 >	2,4
	Actyon	2006 >	2,4
	Korando	2011 >	2,4
	Musso Pickup	2016 >	2,4
	Rexton	2014 >	2,4
	Tivoli	2015 >	2,4
	Turismo	2014 >	2,4
	Forester	2013 >	2,4
Subaru	Impreza 5dr	2007 >	2,4
	Impreza Hatchback	2013 >	2,4
	Legacy	2012 >	2,4
	Levorg	2014 >	2,4
	Outback	2012 >	2,4
	XV Hatchback	2011 >	2,4
Suzuki	Baleno	2016 >	2,4
	Celerio	2016 >	2,4
	Grand Vitara	2005 >	2,4
	Ignis	2016 >	2,4
	SX-4 5dr	2006 >	2,4
	Swift	2017 >	2,4
	Vitara	2015 >	2,4

Car manufacturer	Model	1st year of production	Approved seats
Tesla	Model 3	2017 >	2,4
	Model S	2012 >	2,4
	Model X	2015 >	2,4,5,7
Toyota	Verso	2013 >	2,4
	Auris	2007 >	2,4
	Avenis Hatch	2003 >	2,4
	Aygo	2019 >	2,4
	C-HR	2017 >	2,4
	Corolla	2018 >	2,4
	EZ Mpv	2013 >	2,4
	Highlander	2013 >	2,4
	Land Cruiser	2003 >	2,4
	Landcruiser	2009 >	2,4
	Prius 2	2004 >	2,4
	Prius 3	2010 >	2,4
	Prius 4	2015 >	2,4
	Prius PHEV 3	2015 >	2,4
	Prius Plus+	2012 >	2,4
	RAV4	2006 >	2,4
	RAV4 Hybrid	2015 >	2,4
	Yaris	2017 >	2,4
VW	Beetle	2012 >	2,4
	E-Golf Hatch Mk7	2015 >	2,4
	Golf GTE Hatch Mk7	2015 >	2,4
	Golf Hatch	2009 >	2,4
	Golf Hatch Mk5	2004 >	2,4

Car manufacturer	Model	1st year of production	Approved seats
	Golf Hatch Mk7	2012 >	2,4
	Golf Plus	2009 >	2,4
	ID3 EV	2020 >	2,4
	ID4 EV	2021 >	2,4
	Jetta	2011 >	2,4
	Multivan Caravelle	2008 >	2,4,5,7
	Passat CC	2008 >	2,4
	Passat Estate	2005 >	2,4
	Passat Saloon	2005 >	2,4
	Polo	2017 >	2,4
	Scirocco	2011 >	2,4
	T-Cross	2019 >	2,4
	T-Roc	2017 >	2,4
	Tiguan	2008 >	2,4
	Tiguan Allspace	2017 >	2,4
	Touareg	2003 >	2,4
	Touran	2016 >	2,3,4,5,7
Vauxhall	Agila	2008 >	2,4
	Ampera	2011 >	2,4
	Antara	2007 >	2,4
	Astra 5dr	2010 >	2,4
	Astra	2015 >	2,4
	Astra GTC	2011 >	2,4
	Corsa 5dr	2015 >	2,4
	Corsa Hatch 5dr	2006 >	2,4
	Insignia Hatch	2009 >	2,4

Car manufacturer	Model	1st year of production	Approved seats
	Meriva	2010 >	2,4
	Mokka	2013 >	2,4
	Vectra	2005 >	2,4
	Zafira	2005 >	2,4
	Zafira Tourer	2012 >	2,4
	Opel Crossland X	2018 >	2,4
	Opel Grandland X	2019 >	2,4
	Opel Insignia	2018 >	2,4
Volvo	C30	2007 >	2,4
	S40	2004 >	2,4
	S90	2016 >	2,4
	V40	2013 >	2,4
	V40 Cross Country	2013 >	2,4
	V50	2004 >	2,4
	V60	2011 >	2,4
	V60 Plug-In	2015 >	2,4
	V90	2016 >	2,4
	XC40	2018 >	2,4
	XC60	2013 >	2,4
	XC70	2008 >	2,4
	XC90	2003 >	2,4



nado GmbH
Langgasse 15
95326 Kulmbach Germany
www.babynado.de